

RETRO TABLE LAMP KATKA



CONTENTS OF THE PACKAGE

1x Lamp (1,5 m cable) 1x User Manual

TECHNICAL SPECIFICATIONS

SOCKET TYPE	E27
INPUT VOLTAGE	220–240 V (50/60 Hz)
DEGREE OF PROTECTION	IP20
MATERIAL	METAL + WOOD
CABLE LENGHT	1,5 M

SAFETY INSTRUCTIONS:

- Do not connect the lamp to the power supply while it is still in its packaging.
- Avoid damaging the cable.
- If the lamp does not light up, check that the bulb is properly inserted in the socket.
- The lamp is **for indoor use only** – do not use near water or in humid environments.
- If the power cable is damaged, it must be replaced only by the manufacturer, their service representative, or a similarly qualified person to avoid a safety hazard.

BULB REPLACEMENT

- Ensure the lamp is unplugged from the power supply.
- Unscrew the old bulb and replace it with a new one of the same type.

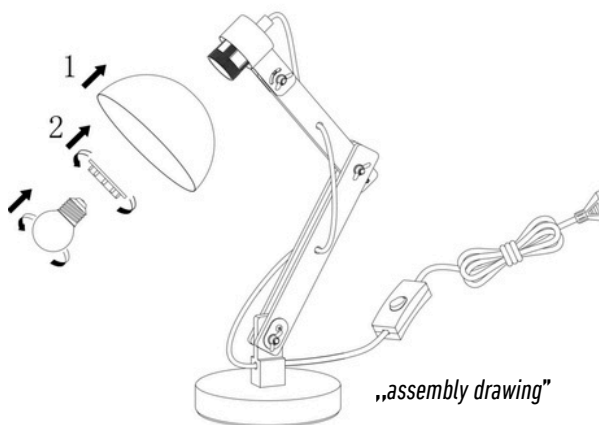

DISPOSAL AND RECYCLING INFORMATION

All products with this label must be disposed of in accordance with the regulations for the disposal of electrical and electronic equipment (Directive 2012/19/EU). Their disposal together with normal municipal waste is not permitted. Dispose of all electrical and electronic appliances in accordance with all local and European regulations at designated collection points with the appropriate authorisation and certification according to local and legislative regulations. Proper disposal and recycling helps to minimise environmental and human health impacts. For further information on disposal, please contact your dealer, authorised service centre or local authorities.

EU DECLARATION OF CONFORMITY

Tesla Lighting, Ltd. hereby declares that the DE02PTB-1/DE02PTS-1 complies with EU directives.